

NEW!
More on reverse

COMMERCIAL GRADE Box Extenders

Trimable • Listed • Extends Set Back Boxes Up to 1-1/2 inches

Heavy-duty Non-metallic Box Extender with Galvanized Steel Support

NEW! COMMERCIAL GRADE

NEW! Two-gang BE2XLS

BE1XLS
Single gang as shipped

Ready for use with Maxi Plates...

Trimable for use with Mid- and Standard Wall Plates

Trim along line with snips for Mid-size Cover Plates

Standard Cover Plate Cutting guideline

Ready for installation of standard wall plate

Arlington's heavy duty, commercial-grade Box Extenders save time! They're convenient too.

They *extend* set back metallic and non-metallic electrical boxes *up to 1-1/2"*, and work with maxi, midi and standard wall plates.

BE1XLS and **BE2XLS** ship ready to use with a maxi cover plate – great for hiding poorly cut drywall. They're also trimmable for use with mid-size and standard wall plates.

- Non-metallic box extender with galvanized steel support plate

- Levels, supports wiring devices; protects wires against damage and stripping

- **2-Hour Fire Rating**
- cULus Listed



*If the edge of the box, plaster ring or box extender will be set back from the finished surface LESS THAN 1/4" use our **NEW Device Support Plates** (see reverse)*

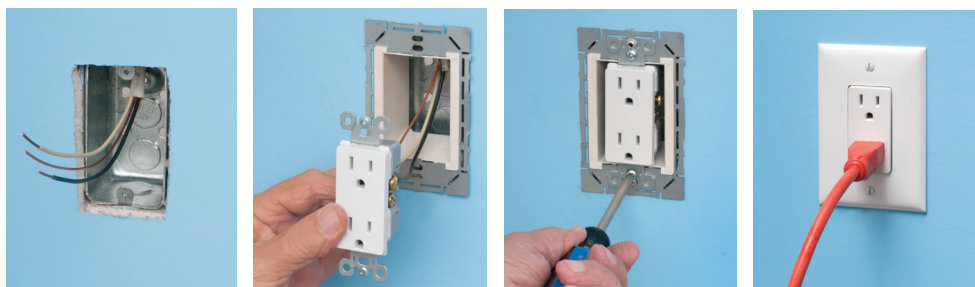

Catalog Number	UPC/DEI/NAED Mfg. #018997	Description	Unit Pkg	Std Pkg
BE1XLS	40172	Single Gang Heavy duty, Non-metallic Box Extender	20	20
BE2XLS	99331	Two-Gang Heavy duty, Non-metallic Box Extender	10	10

Commercial Grade w/ galvanized steel support plate • Extends set back boxes up to 1-1/2"

TWO HOUR FIRE RATING

© 2024 Arlington Industries, Inc.



Patent pending

Arlington®

1 Stauffer Industrial Park
Scranton, PA 18517
800/233.4717 • Fax 570/562.0646
www.aifittings.com

Metal Device Support Plates **NEW!**

The EASY WAY to Flush Trim Finish Poorly Cut Drywall

Use Arlington's single and two-gang metallic **Device Support Plates** where the edge of the box, plaster ring or box extender **WON'T** be set back from the finished surface more than 1/4" (6 mm) per NEC 314.20..

- Easily solve the problem of poorly cut drywall – obtain a flush trim finish
- Galvanized steel support plate levels, supports wiring devices
- Trimmable as needed to fit Standard, Mid-size and Jumbo Wall Plates

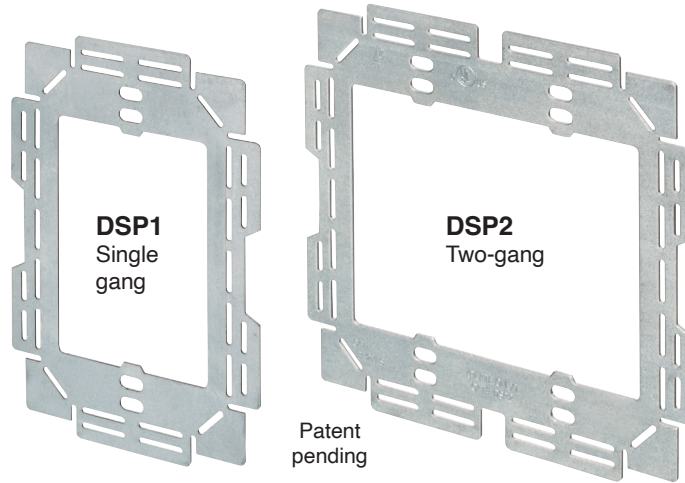

Note

For use where edge of box is NOT set back more than 1/4" per NEC 314.20.

If set back is greater than 1/4" use BE1XLS or BE2XLS commercial grade box extender. See reverse side of sheet



Installation Instructions

(DPS2 shown)



- 1 Place Device Support Plate on the wall opening to determine the amount of coverage needed. Select the necessary wall plate Jumbo, Mid-size or Standard.

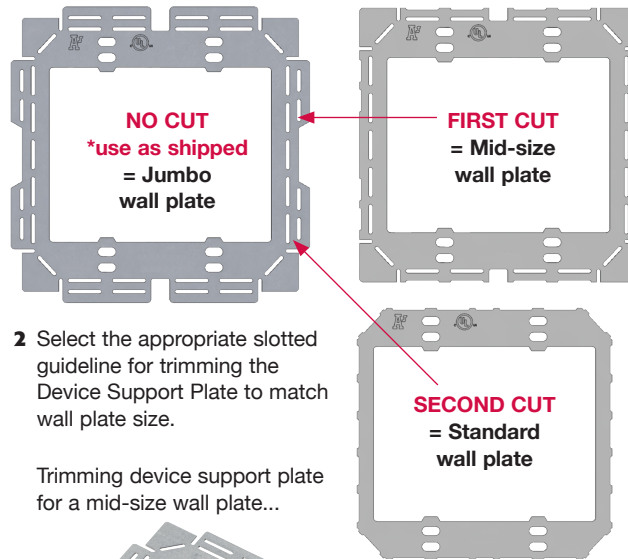
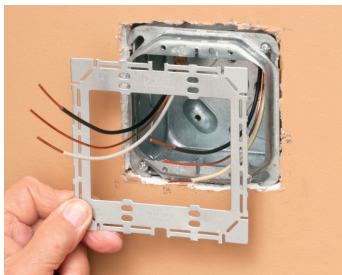

Trimming device support plate for a mid-size wall plate...

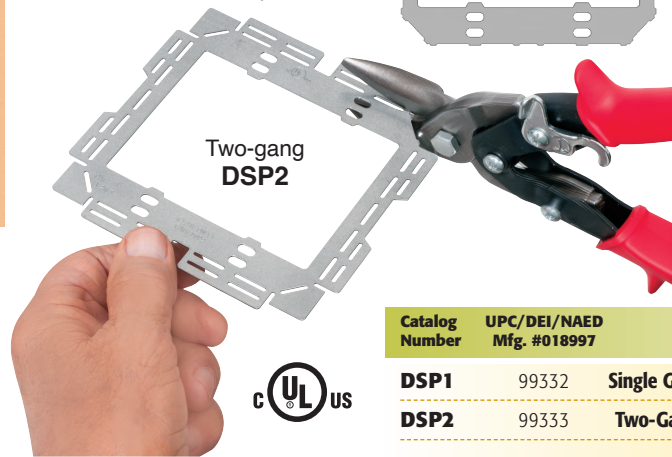

- 3 Install device through screw holes in Device Support Plate.
- 4 Install wall plate for a flush device and wall plate trim finish.



Arlington®

1 Stauffer Industrial Park
Scranton, PA 18517
800/233.4717 • Fax 570/562.0646
www.aifittings.com



Catalog Number	UPC/DEI/NAED Mfg. #018997	Description Device Support Plate	Unit Pkg	Std Pkg
DSP1	99332	Single Gang Metallic Device Support Plate	10	100
DSP2	99333	Two-Gang Metallic Device Support Plate	5	50



Distributed by