

## SNAP<sup>2</sup>IT<sup>®</sup> Duplex Connectors with Insulated Throat

Zinc die-cast. For AC • MCI-A • HCF steel and aluminum cable • Flexible metal conduit steel and aluminum (regular and reduced wall) • MCI cable • Continuous corrugated aluminum • ACG90 • AC90.



383810AST



404010AST

CATALOG NUMBER	UPC/DCI/NAED MFG #018997	TRADE SIZE	KO SIZE	UNIT PKG	STD PKG	DIM A	DIM B	DIM C	DIM D	CABLE RANGE
383810AST	10937	3/8	1/2	25	100	2.398	2.035	.840	.624	(2) .370 - .490
404010AST†	40533	3/8	1/2	25	100	2.398	2.165	.840	.624	(2) .405 - .612
505010AST	50720	1/2	3/4	25	25	3.054	2.717	1.058	.810	(2) .590 - .920

†Provided with red tinted inside clips so you can tell the difference between a 383810AST to 404010AST.

Refer to chart on page E-22 for a list of cable types. Refer to chart on page E-25 for MCI-A cable ranges.

Concrete tight when taped.

SNAP-TITE<sup>®</sup> and SNAP<sup>2</sup>IT<sup>®</sup> products have been tested and listed by UL in accordance with UL's ground fault requirements.

For additional information see page 7.

PATENTED.

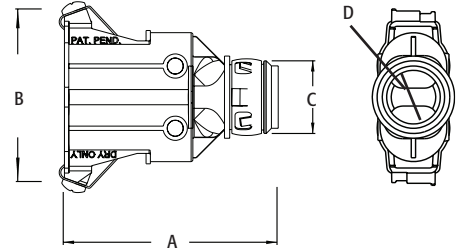

**Secure hold – Easy cable insertion!**  
Simply snap the cable into the fitting and snap it into the box...no tools needed!  
The screw only holds the clip in place.